

CERTIFIED LAND CORNER RECORDATION

DESCRIPTION OF CORNER EVIDENCE FOUND, AND ORIGINAL RECORD (If known)

T. 14 N.
R. 67 W. R. 66 W.
W. C.
36 | 31
16
T. 13 N.

FOUND: NO EVIDENCE OF PREVIOUS MONUMENTATION

SET: IRON PIPE 2-1/2" x 28" x 20" IN THE GROUND W/ 3" BRASS CAP, MARKED AS SHOWN BELOW. CORNER POSITION ESTABLISHED FROM EXISTING MONUMENTATION FOUND IN SURROUNDING SUBDIVISIONS.

DESCRIPTION OF MONUMENT AND ACCESSORIES ESTABLISHED TO PERPETUATE THE ORIGINAL LOCATION OF THIS CORNER:

SEE TIES BELOW

SKETCH, WITH COURSE AND DISTANCE TO ADJACENT CORNER IF DETERMINED IN THIS SURVEY.
(May Sketch or Paste Reproduction on Reverse Side.)

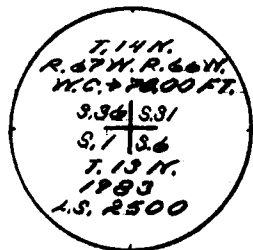
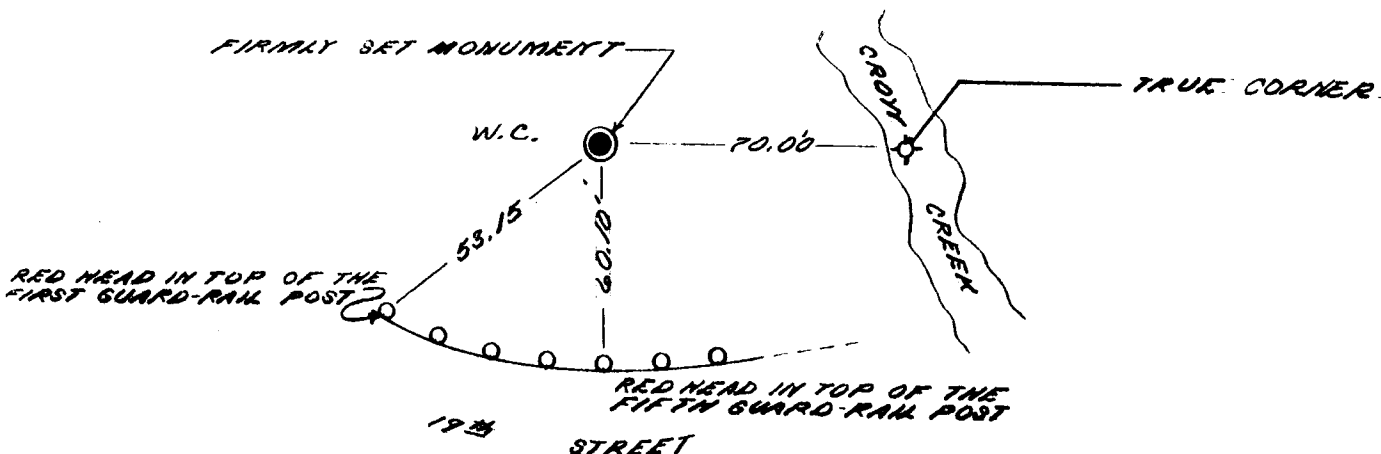

I, JOHN A. STELL certify that I have carefully performed or reviewed the work done on the diagrammed corner as reported on this recordation form and approve the same.

John A. Stell
Signature of Surveyor L.S. 2500 Registration No.

STATE OF WYOMING,
Office of Clerk and Recorder,
County of Saramie

692561

This "corner record" was filed for record on the _____ day of APR 6 1983, 19____, was noted on the cross-index plat and is assigned page No. _____, in book No. _____.

James C. Whitehead
County Official

Cross Index No. <u>2-1</u>	T. <u>14</u>	R. <u>66</u>	Mer.
_____	T. _____	R. _____	Mer.
_____	T. _____	R. _____	Mer.
_____	T. _____	R. _____	Mer.
_____	T. _____	R. _____	Mer.
_____	T. _____	R. _____	Mer.
_____	T. _____	R. _____	Mer.